

GO-TCHA

for Pokémon GO

User Guide

Thank you for purchasing the Go-tcha for Pokémon GO!

Enjoy Pokémon GO on the move without looking at your smartphone!

What's In The Box?

In your Go-tcha for Pokémon Go box you should receive:

- ⊕ x1 Go-tcha USB device
- ⊕ x1 Go-tcha wrist band
- ⊕ x1 Go-tcha USB charger cable

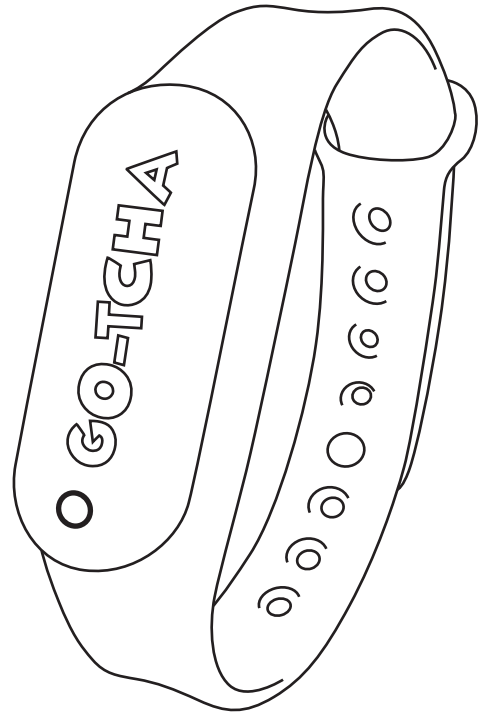

Connecting Your Go-tcha

To connect your Go-tcha to the Pokémon App:

- ⊕ Open the Pokémon GO App
- ⊕ Touch the Main Menu
- ⊕ Touch Settings
- ⊕ Touch 'Pokémon GO Plus'
- ⊕ Press the button on the Go-tcha to make it discoverable to the Pokémon Go App
- ⊕ Touch your 'Pokémon GO Plus' under Available Devices list to connect.

Using Your Go-tcha - Manual Catch

- ⊕ Go-tcha will vibrate and animate the screen to show a new/duplicate Pokémon is near.
- ⊕ Press the Go-tcha button/screen to catch the Pokémon.
- ⊕ Go-tcha will vibrate and animate the screen to show a successful/unsuccessful catch.

- ⊕ Go-tcha will vibrate and animate the screen to show when a Pokéstop is in range.
- ⊕ Press the Go-tcha button to retrieve items from a Pokéstop.
- ⊕ Go-tcha will vibrate and animate the screen to show it has successfully/unsuccessfully collected the items and how many items it has collected.

See 'Go-tcha Screens' on pages 2-4 of this User Guide for a complete guide to the screen animation alerts.

Using Your Go-tcha - Auto Catch

To turn the 'Auto-catch' function on, press the the Go-tcha button until '**Auto-catch ON**' is selected.

If you have Auto Catch on:

- Go-tcha will vibrate and animate the screen to show a successful/unsuccessful catch.
- Go-tcha will vibrate and animate the screen to show it has successfully/unsuccessfully collected the items and how many items it has collected at a Pokéstop.

To turn 'Auto-catch' off, press and hold the Go-tcha button until '**Auto-catch OFF**' is selected.

Charging Your Go-tcha

The Go-tcha charges via USB. Simply remove the Go-tcha USB device from the wrist band, slide it into the charger and connect to a USB power source.

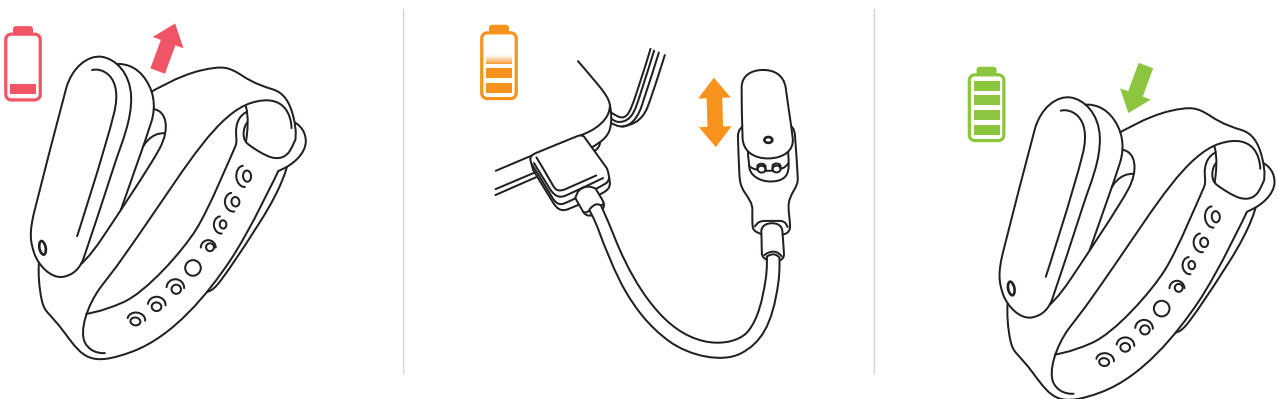

Simply return the Go-tcha to the bracelet when fully charged. A full charge takes approx. 1 hour and lasts for approx. 12 hours with continuous use. Standby time is approx. 48 hours.

IMPORTANT Please check that the Go-tcha is inserted correctly into the charger cable - Push the Go-tcha **FIRMLY** into the cable to ensure that it is fully seated. Once inserted correctly you can check that your Go-tcha is charging by pressing the screen button. The charging animation will appear to confirm that the Go-tcha is charging. If there is any other Go-tcha animation running, then wait for the animation to stop and the screen is blank - now press the screen button to confirm the charging animation is displayed.

If the charge animation is not showing then your Go-tcha is **NOT** charging.

TROUBLE SHOOTING.

Make sure that the Go-tcha is pressed firmly into the charger cable and repeat the above steps.

The charger cable is made from soft material and can get pushed out of shape - if the Go-tcha unit feels loose when inserted or battery animation does not show, then gently squeeze the sides of the cable slot/cradle tightly together and then re-insert the Go-tcha unit - if the charge animation is still not showing, repeat these steps.

Make sure that the USB port is providing constant power. Many devices with power saving modes will turn off power to the USB port if there is no USB device present.

Even though Go-tcha charges from a USB port it is not seen as a USB device. Some rechargeable power packs will also stop powering if a USB device is not present.

Go-tcha Screens - Catching/Caught Pokemon



Auto-catch
ON



Auto-catch
OFF



Auto-catch
new Pokémon
ONLY ON



Auto-catch
new Pokémon
ONLY OFF



New Pokémon
discovered



Duplicate
Pokémon found



Waiting



Pokémon
caught



Pokémon not
caught

Go-tcha Screens - Pokéstops



Auto-collect
Pokéstop ON



Auto-collect
Pokéstop OFF



Pokéstop
in range



Pokéstop not
in range



Pokéstop items
collected



Pokéstop items not collected



x2 Pokéstop items collected



x3 Pokéstop items collected



x4 Pokéstop items collected



5+ Pokéstop items collected

Go-tcha Screens - Other alerts



Go-tcha intro screen



Out of Pokéballs



Open journal to see escaped Pokémon



Device is paired



Device not paired



Vibration alerts **ON**



Vibration alerts **OFF**



Charging*
*See charging notes on page 2



THIS PRODUCT IS NOT SPONSORED, ENDORSED, OR APPROVED BY THE POKÉMON COMPANY OR NIANTIC.

Device requires Bluetooth low-energy compatible smartphone with Pokémon GO app installed. Compatible with iPhone® 5 / 5c / 5s / SE / 6 / 6s / 6 Plus / 6s Plus / 7 / 7 Plus devices with iOS Ver. 8–10 installed. Compatible with Android devices with 2 GB RAM or more, Bluetooth Smart (Bluetooth Ver. 4.0 or higher) capability, and Android Ver. 4.4–6.0 installed.

Auto Catch features and Update 1.53.2

Go-tcha users who have updated to version 1.53.2 may have encountered an issue with the Auto Catch features. This problem is triggered if users update to version 11.1.2 on their iOS device.

This issue has been dealt with on units that are now shipping and a firmware update for current Go-tcha users is available on the [Apple App Store](#)

All other Go-tcha features are unaffected enabling use of the button to catch when prompted by the Go-tcha animation.

Service Status visit www.go-tcha.co.uk

Software Update

Software updates for Go-tcha are now available in the Apple App Store. The latest update resolves the issues with **Auto Catch features on iOS devices**



No updates are currently required for Android devices.

Technical Support

Before contacting Datel's customer service department, please ensure that you have read through and understood the information in this manual/guide. If you contact support, please ensure that you have information on when and where you purchased this product to hand.

Datel Customer Services Europe

Customers Services, Datel Ltd,
Stafford Road,
Stone,
Staffordshire,
ST15 0DG.
UNITED KINGDOM

Email: customer.service@codejunkies.com

Web: <http://support.codejunkies.com/>



© 2017 Datel Ltd. PowerSaves is a trademark of Datel Ltd. Pokémon is a trademark or registered Trademark of the POKÉMON COMPANY. All other trademarks are the property of their respective owners. Go-tcha for Pokémon Go is a 100% unofficial product and is NOT sponsored, endorsed or approved by NINTENDO, nor any games developer or publisher.

